

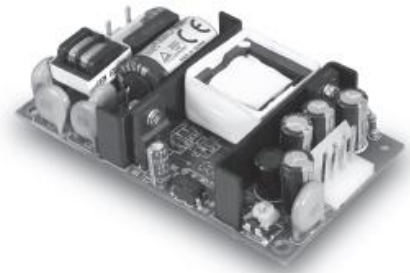

## 20 Watt Open Frame AC/DC Modules Series DVC20



### Features

- Universal Input Range 85 – 264Vac
- PCB Mountable Type Available
- Continuous Short Circuit Protection
- UL62368-1 Approved
- Efficiency at 81% Typical
- Leakage Current 0,25mA max.
- Meets EN55032 Class B
- UL60950-1 Approved

MODEL NUMBER	OUTPUT VOLTAGE [ VDC ]	OUTPUT CURRENT MAX. [ mA ]	OUTPUT CURRENT MIN. [ A ]	RIPPLE & NOISE (Note 1)	VOLTAGE ACCURACY [ % ] (Note 2)	LINE REGULATION [ % ] (Note 3)	LOAD REGULATION [ % ] (Note 4)	EFF. [ % ] (Note 5)
DVC20S033	3,3	4400	0	50mV	±1	±0,5	±1	66
DVC20S050	5	4400	0	1%	±1	±0,5	±1	72
DVC20S090	9	2450	0	1%	±1	±0,5	±1	76
DVC20S120	12	1800	0	1%	±1	±0,5	±1	79
DVC20S150	15	1400	0	1%	±1	±0,5	±1	80
DVC20S240	24	920	0	1%	±1	±0,5	±1	81

Note: Please add **-P** for **Pin-Version** (DVC20S240-**P**)

### INPUT CHARACTERISTICS:

Input Voltage Range.....85-264Vac  
 Input Frequency.....47 to 63Hz  
 Inrush Current.....40A max. @ 230Vac  
 Conducted EMI.....CISPR/FCC Class B  
 Leakage Current.....3,5mA max.

### OUTPUT CHARACTERISTICS:

Hold-up Time.....16mS Typ @ 115Vac  
 Short Circuit Protection .. Hiccup Mode (Auto Recovery), Continuous  
 Temperature Coefficient .....±0,05%/°C  
 Over Temperature Protection ..... TVS Component to Clamp

### GENERAL SPECIFICATIONS:

Isolation Voltage (Input/Output) .....4242Vdc  
 Operating Temperature Range.....0°C to +70°C  
 Storage Temperature Range .....-20°C to +85°C  
 Derating ..... see curve  
 Humidity.....93% RH max. non condensing  
 Cooling..... Natural Convection  
 Switching Frequency.....67KHz typ.  
 MTBF (MIL-HDBK-217F,GB,at25°C/115VAC).....300K hrs min.  
 Altitude.....2000m

### MECHANICAL SPECIFICATIONS:

Dimensions ..... DVC20Sxxx:..... 88,92x50,80x23,00 (mm)  
 DVC20Sxxx-P:..... 88,92x50,80x25,40 (mm)  
 Weight.....100g typ.

### SAFETY & EMC:

Emission & Immunity..... EN55032 Class B  
 EN61000-6-3, EN61000-3-2, EN61000-3-3  
 EN55024, EN61204-3, EN61000-6-1  
 Safety.....IEC/EN/UL62368-1 & IEC/EN/UL60950-1

#### NOTE:

1. Add a 0,1µF ceramic capacitor and a 10 µF E.L. capacitor to output for Ripple & Noise Measuring @ 20MHz BW.
2. Voltage accuracy is set at 100% rated load and 25°C Ta.
3. Line Regulation is Measured from High Line to Low Line with Full Load.
4. Load Regulation is Measured from Full to 10% load.
5. Typical efficiency at 230VAC and full load at 25°C.
6. Standard input and output connectors wafer with LONG CHU P3060 series and mate with MOLEX housing 5195 series or equivalent.
7. Model DVC20Sxx-P: Connectors with PCB Mountable Type.
8. Typical at 25°C, nominal line and 75% load, unless otherwise specified.

### DERATING CURVE

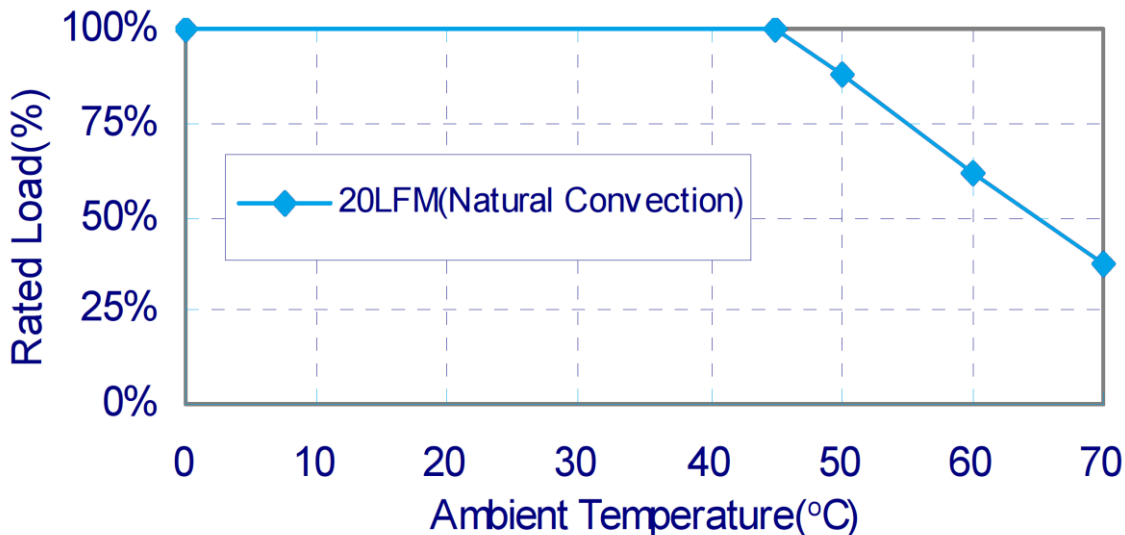

All Dimensions are in Inches (mm)  
 Tolerances:  $x.xx \pm 0.02$  ( $x.xx \pm 0.5$ ) unless otherwise noted

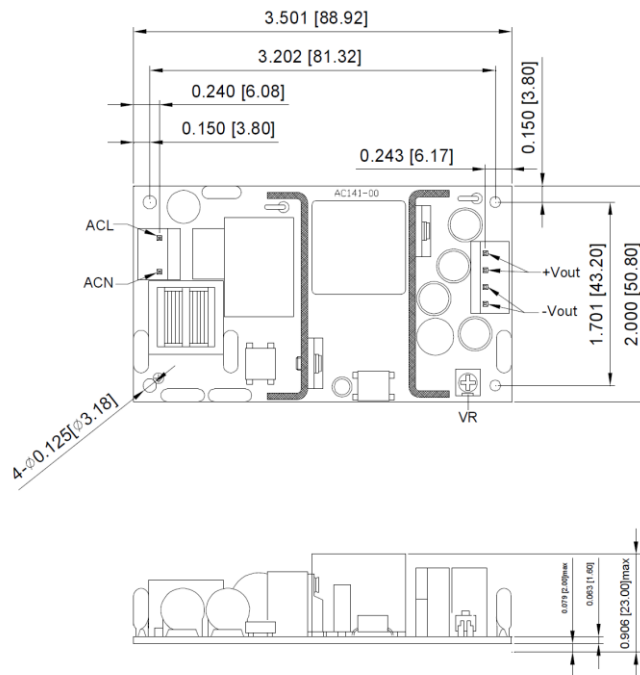

## Model DVC20Sxxx-P (Pin Version)

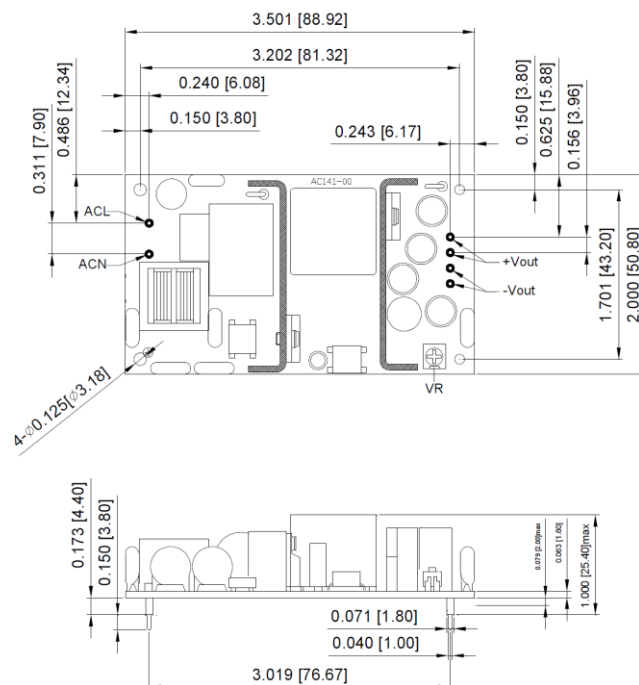

Technische Änderungen vorbehalten / Specifications are subject to change without notice